

1243

1244

INSTRUCTION MANUAL

This instruction manual applies to machines from the following serial numbers onwards:

# 7 250 050 →



This Instruction Manual is valid for all models and subclasses listed in the chapter "**Specifications**".



The adjustment manual for the machines can be downloaded free of charge from the internet address.

**[www.pfaff-industrial.com/pfaff/de/service/downloads](http://www.pfaff-industrial.com/pfaff/de/service/downloads)**

As an alternative to the internet download the adjustment manual can also be ordered in book form under part no. **296-12-19 244/002**

The reprinting, copying or translation of PFAFF Instruction Manuals, whether in whole or in part, is only permitted with our previous authorization and with written reference to the source.

**PFAFF Industriesysteme  
und Maschinen AG**

Hans-Geiger-Str. 12 - IG Nord  
D-67661 Kaiserslautern

		Chapter - Page
	Contents.....	
<b>1</b>	<b>Safety.....</b>	<b>1 - 1</b>
1.01	Directives.....	1 - 1
1.02	General notes on safety .....	1 - 1
1.03	Safety symbols .....	1 - 2
1.04	Important points for the user .....	1 - 2
1.05	Operating and specialist personnel .....	1 - 3
1.05.01	Operating personnel.....	1 - 3
1.05.02	Specialist personnel.....	1 - 3
1.06	Danger warnings.....	1 - 4
<b>2</b>	<b>Proper use.....</b>	<b>2 - 1</b>
<b>3</b>	<b>Specification.....</b>	<b>3 - 1</b>
3.01	PFAFF 1243; PFAFF 1244 .....	3 - 1
3.02	Models and Subclasses.....	3 - 2
3.03	Max. number of stitches/min-1 for the PFAFF 1243 .....	3 - 2
3.04	Max. number of stitches/min-1 for the PFAFF 1244 .....	3 - 2
<b>4</b>	<b>Disposal of Machine .....</b>	<b>4 - 1</b>
<b>5</b>	<b>Transportation, packing and storage .....</b>	<b>5 - 1</b>
5.01	Transportation to customer's premises .....	5 - 1
5.02	Transportation to customer's premises .....	5 - 1
5.03	Disposal of packing materials .....	5 - 1
5.04	Storage .....	5 - 1
<b>6</b>	<b>Explanation of symbols .....</b>	<b>6 - 1</b>
<b>7</b>	<b>Controls.....</b>	<b>7 - 1</b>
7.01	On/off switch.....	7 - 1
7.02	Pedal (on machines without subclass -911/97).....	7 - 1
7.03	Pedal (on machines with subclass -911/97).....	7 - 2
7.04	Knee lever (on machines without subclass -911/97 ).....	7 - 2
7.05	Key on machine head (on machines with subclass -911/97).....	7 - 3
7.06	Lever for lifting the roller presser .....	7 - 3
7.07	Feed regulator / reverse sewing.....	7 - 4
7.08	Feed regulator (on machines with subclass -911/97).....	7 - 4
7.09	Control panel ( on machines with attached motor ) .....	7 - 5
<b>8</b>	<b>Installation and commissioning.....</b>	<b>8 - 1</b>
8.01	Installation.....	8 - 1
8.01.01	Adjusting the table-top height .....	8 - 1
8.01.02	Assembling the motor (only on machines with motor) .....	8 - 2
8.01.03	Tightening the V-belt .....	8 - 2
8.01.04	Mounting the bottom V-belt guard .....	8 - 3

---

Contents .....	Chapter - Page
8.01.05	Mounting the upper V-belt guard ..... 8 - 4
8.01.06	Fitting the synchronizer..... 8 - 4
8.01.07	Fitting the tilt lock ..... 8 - 5
8.01.08	Fitting the reel stand ..... 8 - 5
8.02	Connecting the plug-in connections and earth cables ..... 8 - 6
8.03	Commissioning ..... 8 - 7
8.04	Switching the machine on/off ..... 8 - 7
8.05	Basic position of the machine drive unit ..... 8 - 8
<b>9</b>	<b>Setting up ..... 9 - 1</b>
9.01	Inserting the needle on the PFAFF 1243..... 9 - 1
9.02	Inserting the needle on the PFAFF 1244 ..... 9 - 2
9.03	Winding the bobbin thread, regulating the winder tension ..... 9 - 3
9.04	Changing the bobbin..... 9 - 4
9.05	Threading the bobbin thread and regulating the bobbin thread tension..... 9 - 4
9.06	Threading needle thread/adjusting needle thread tension ( on the PFAFF 1243 ) ..... 9 - 5
9.07	Threading needle thread/adjusting needle thread tension ( on the PFAFF 1244 ) ..... 9 - 6
9.08	Adjusting the stitch counter for the bobbin thread control..... 9 - 7
<b>10</b>	<b>Care and maintenance..... 10 - 1</b>
10.01	Servicing and maintenance intervals..... 10 - 1
10.02	Cleaning the hook compartment and the hook ..... 10 - 1
10.03	General oiling..... 10 - 2
10.04	Oiling the sewing hook ..... 10 - 3
10.05	Oiling the needle-head parts ..... 10 - 4
10.06	Checking/regulating the air pressure ..... 10 - 4
10.07	Emptying/cleaning the water bowl of the air filter/regulator ..... 10 - 5
10.08	Parameter settings ..... 10 - 6
10.08.01	Parameter list ..... 10 - 6
<b>11</b>	<b>Mounting the table top and Circuit diagrams ..... 11 - 1</b>
11.01	Table top cutout ..... 11 - 1
11.02	Mounting the table top..... 11 - 2
11.03	Circuit diagrams ..... 11 - 3
<b>12</b>	<b>Wearing parts ..... 12 - 1</b>

---

## **1 Safety**

### **1.01 Regulations**

This machine has been made according to the European regulations indicated in the conformity and manufacturer's declarations.

In addition to this instruction manual, please also observe all generally accepted statutory and other legal requirements, including those of the user's country, and the valid pollution control regulations!

The locally valid regulations of the social insurance institution responsible for occupational accidents, or other supervisory authorities, must be strictly adhered to!

### **1.02 General notes on safety**

- The machine must only be operated when the instruction manual has been fully read and understood, and only by operators who have had the necessary training!
- All notes on safety and the instruction manual of the motor manufacturer must be read before the machine is put into operation!
- All notices on the machine referring to danger and safety must be observed!
- The machine must be used for the purpose it is intended for and must not be operated without its safety devices; all regulations relevant to safety must be adhered to.
- When part sets are changed (e.g. needle, presser foot and needle plate), during threading, when the workplace is left unattended and during maintenance work, the machine must be isolated from the power supply by pressing the on/off switch or removing the plug from the mains!
- Daily maintenance work must only be carried out by appropriately trained persons!
- Repairs and special maintenance work must only be carried out by qualified technical staff or persons with the appropriate training! Exceptions to this are only allowed for adjustment and function checks by appropriately trained personnel!
- Repair work and special maintenance work must only be carried out by technical personnel or by persons with the appropriate training!
- Work on the electrical equipment must only be carried out by technical staff who are qualified to do so!
- Work on parts or equipment connected to the power supply is not permitted! The only exceptions to this are specified in regulations EN 50110.
- Conversion or modification of the machine must only be carried out under observation of all relevant safety regulations!
- Only spare parts which have been approved by us are to be used for repairs! We draw special attention to the fact that spare parts and accessories not supplied by us have not been subjected to testing nor approval by us. Fitting and/or use of any such parts may cause negative changes to the design properties of the machine. We shall not accept any liability for damage caused by the use of non-original parts.

## 1.03

### Safety symbols



Danger!  
Special points to observe



Danger of injury to operating or technical staff!

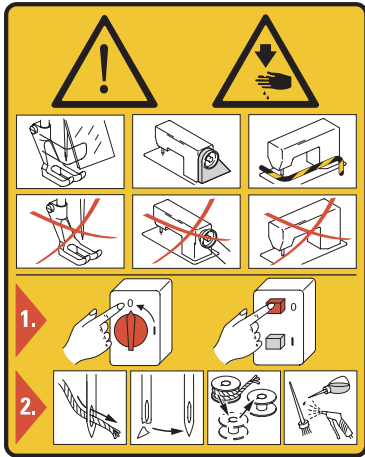

### Caution

Do not operate without finger guard and safety devices.  
Before threading, changing bobbin and needle, cleaning  
etc. **switch off main switch.**

## 1.04

### Important notes for the user

- This instruction manual is part of the equipment of the machine and must be available to the operating staff at all times.
- The instruction manual must be read before the machine is operated for the first time.
- Both operating and technical staff must be instructed on the safety devices of the machine and on safe working methods.
- It is the duty of the user to operate the machine in perfect running order only.
- The user must ensure that none of the safety devices are removed nor put out of working order.
- The user must ensure that only authorized persons operate and work on the machine.

For further information please refer to your PFAFF agency.

## 1.05 Notes for operating and technical staff

### 1.05.01 Operating staff

Operating staff are the persons responsible for setting up, operating and cleaning the machine and for removing any disturbances in the sewing area.

The operating staff are obliged to observe the following points, and must:

- always observe the notes on safety in this instruction manual!
- avoid using any working methods which adversely effect the safety of the machine!
- avoid wearing loose-fitting clothing or jewelry such as necklaces or rings!
- also ensure that only authorized persons are allowed near the danger area of the machine!
- immediately report to the user any changes to the machine that may affect its safety!

### 1.05.02 Technical staff

Technical staff are persons who have been trained in electrical engineering, electronics, pneumatics and mechanical engineering. They are responsible for lubricating, servicing, repairing and adjusting the machine.

The technical staff are obliged to observe the following points, and must:

- always observe the notes on safety in this instruction manual!
- switch off the on/off switch before carrying out adjustment and repair work and ensure it cannot be switched on again unintentionally!
- never work on parts or equipment still connected to the power supply! Exceptions to this are only permissible according to regulations EN 50110;
- isolate the machine from the compressed air supply when carrying out maintenance or repair work on pneumatic equipment!  
Exceptions to this are only permissible for function checks;
- replace all safety covers after carrying out maintenance or repair work!

## 1.06

### Danger warnings



A working area of **1 m** must be kept free both in front of and behind the machine, so that easy access is possible at all times.



Never put your hands or fingers in the sewing area during sewing!  
Danger of injury by the needle!



While setting or adjusting the machine do not leave any objects on the table nor in the needle plate area! Objects may be trapped or flung out of the machine!



When a mechanically operated clutch motor without actuation lock is switched off, always wait until the motor has stopped! Danger of injury!

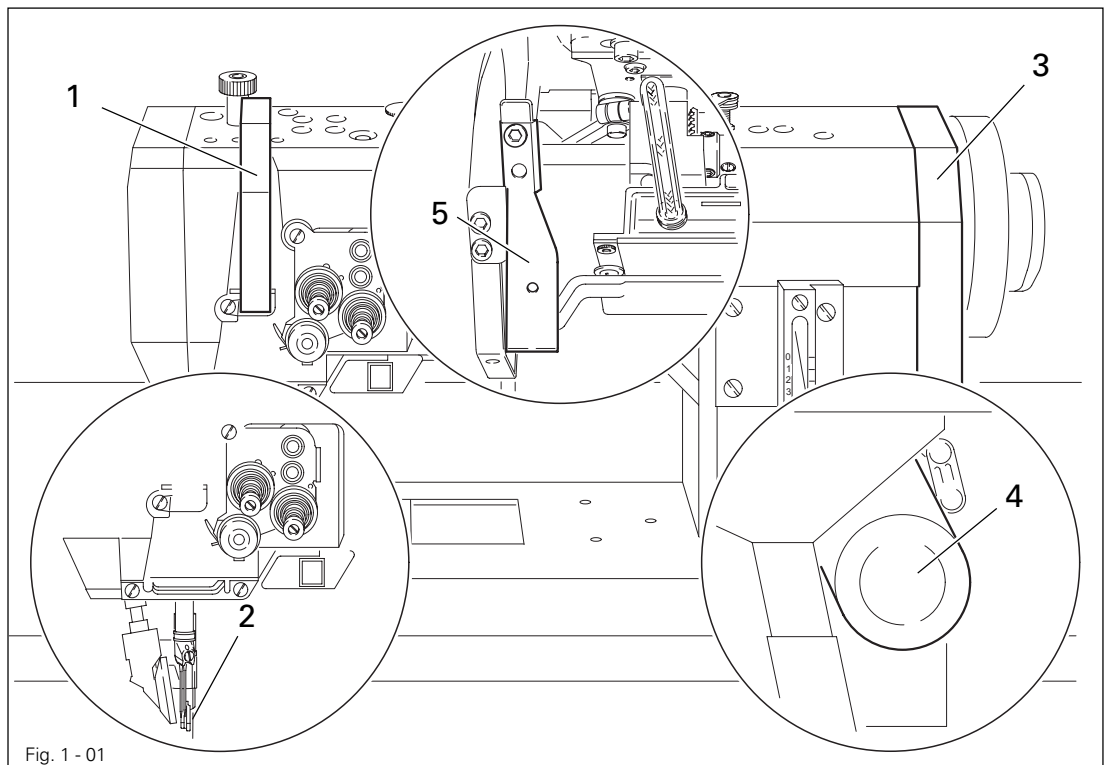

Fig. 1 - 01



Do not run the machine without take-up lever guard **1**!  
Danger of injury by moving take-up lever!



Do not operate machines with a presser foot without the finger guard **2**!  
Danger of injury by the moving needle!



Do not operate the machine without belt guards **3** and **4**!  
Danger of injury by the revolving drive belt!



Do not operate the machine without tilt-back safeguard **5**!  
Danger of fingers being crushed if the machine closes accidentally!



2

**Proper use**

The **PFAFF 1243** is a single-needle lockstitch sewing machine with roller presser and large vertical sewing hook.

The **PFAFF 1244** is a two-needle lockstitch sewing machine with roller presser and large vertical sewing hook.

The machines are used for producing lockstitch seams in the textile and leather industries.



Any use of these machines which is not approved by the manufacturer shall be considered as improper use! The manufacturer shall not be liable for any damage arising out of improper use! Proper use shall also be considered to include compliance with the operation, adjustment, service and repair measures specified by the manufacturer!

---

# Specifications

---

## 3 Specifications

### 3.01 PFAFF 1243, PFAFF 1244 ♦

Stitch type: ..... 301 ( lockstitch )  
Needle system..... 134  
Needle size in 1/100 mm: ..... 110 - 140

Max. thread size ( synthetic \*): ..... 15/3

Max. stitch length:  
Version CN8 : ..... 8,0 mm

Effective dia. of balance wheel: ..... 90 mm

Dimensions of the machine:  
Length:..... approx. 530 mm  
Breadth:..... approx. 177 mm  
Height (above table):..... approx. 265 mm

Clearance width: ..... 270 mm  
Clearance height: ..... 115 mm  
Fabric clearance under roller presser ..... 5 mm

Net weight (machine head):..... approx.42 kg

Motor data: ..... see motor specification plate  
Working pressure:..... 6 bar  
Air consumption:..... ~0,8 l litres/work cycle

Noise data:  
Emission sound level at the workplace at appropriate speed  
( Noise measurement in accordance with DIN 45 635-48-A-1,ISO 11204, ISO 3744, ISO 4871 )  
PFAFF 1243 at a speed of 1500 spm.: .....  $L_{pA} = 79$  dB(A) ■  
PFAFF 1244 at a speed of 1400 spm.:.....  $L_{pA} = 79$  dB(A) ■

- ♦ Subject to technical alterations
- \* Or comparable sizes of other thread types
- $K_{pA} = 2,5$  dB

## 3.02 Models and subclasses

Model CN8 : ..... For processing medium-heavy materials

Additional equipment:

Subclass -4/01 ..... Roller presser

Subclass -900/56 ..... Thread trimmer

Subclass -911/97 ..... Automatic presser-foot lifter with backtacking mechanism

## 3.03 Max. speeds of the PFAFF 1243

Type of machine	Model	Max.speed (r.p.m.)
PFAFF 1243	CN8	2100

## 3.04 Max. speeds of the PFAFF 1244

Type of machine	Model	Max.speed (r.p.m.)
PFAFF 1244	CN8	2000

### 4 Disposal of Machine

- Proper disposal of the machine is the responsibility of the customer.
- The materials used for the machine are steel, aluminium, brass and various plastic materials.  
The electrical equipment comprises plastic materials and copper.
- The machine is to be disposed of according to the locally valid pollution control regulations; if necessary, a specialist is to be commissioned.



Care must be taken that parts soiled with lubricants are disposed of separately according to the locally valid pollution control regulations!

### **5 Transportation, packing and storage**

#### **5.01 Transportation to customer's premises**

The machines are delivered completely packed.

#### **5.02 Transportation inside the customer's premises**

The manufacturer cannot be made liable for transportation inside the customer's premises nor to other operating locations. It must be ensured that the machines are only transported in an upright position.

#### **5.03 Disposal of packing materials**

The packing materials of this machine comprise paper, cardboard and VCE fibre. Proper disposal of the packing material is the responsibility of the customer.

#### **5.04 Storage**

If the machine is not in use, it can be stored as it is for a period of up to six months, but it should be protected against dust and moisture.

If the machine is stored for longer periods, the individual parts, especially the surfaces of moving parts, must be protected against corrosion, e.g. by a film of oil.

---

## Explanation of symbols

---

### 6 Explanation of symbols

In this instruction manual, work to be carried out or important information is accentuated by symbols. These symbols have the following meanings:



Note, information



Cleaning, care



Lubrication

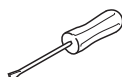

Maintenance, repairs, adjustment, service work  
(only to be carried out by technical staff)

7 Controls

7.01 On/off switch

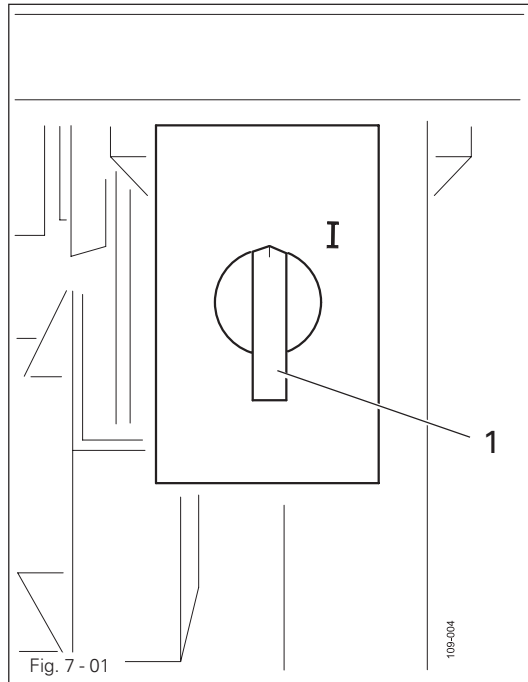

- The power supply to the machine is switched on or off by turning switch 1.



The illustrated on/off switch is fitted to machines with motors. If other motors are used, a different switch may be fitted.

7.02 Pedal ( on machines without subclass -911/97)

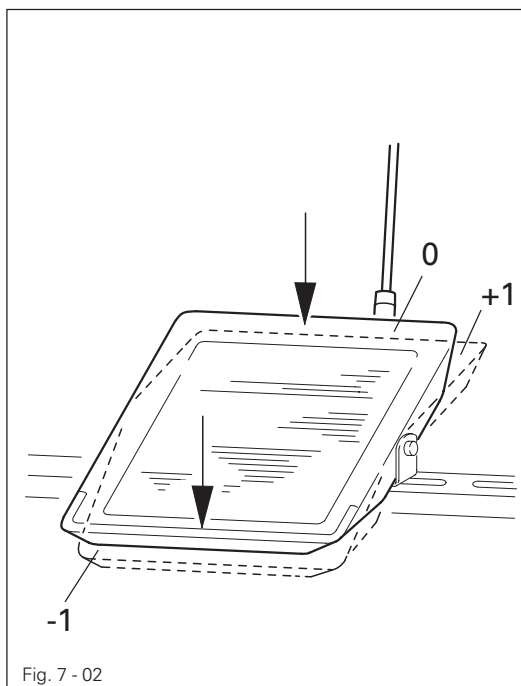

- 0 = Neutral position
- +1 = Sewing
- 1 = Thread trimming (on machines with thread trimmer)

## 7.03 Pedal (on machines with subclass -911/97)

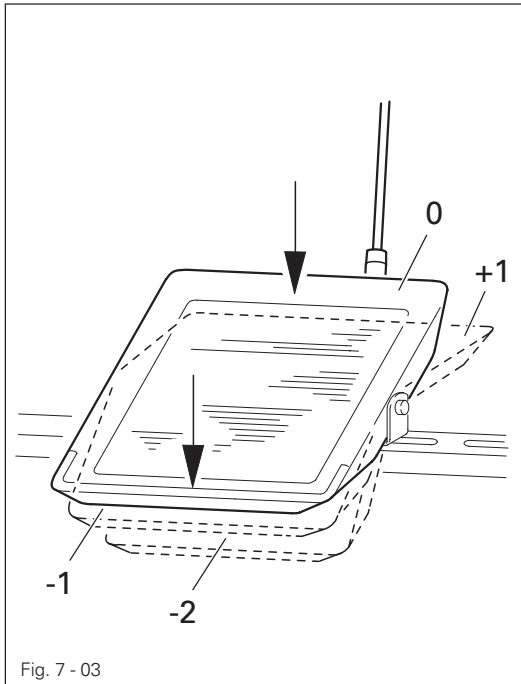

- 0 = Neutral position
- +1 = Sewing
- 1 = Raise presser foot
- 2 = Thread trimming (on machines with thread trimmer)

## 7.04 Knee lever (on machines without subclass -911/97)

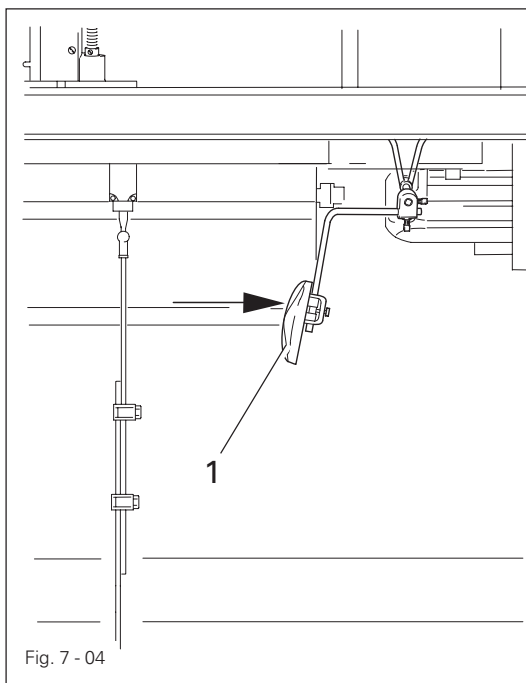

- The presser foot is raised by pressing knee lever 1.



7.05 Key on machine head (on machines with subclass -911/97)

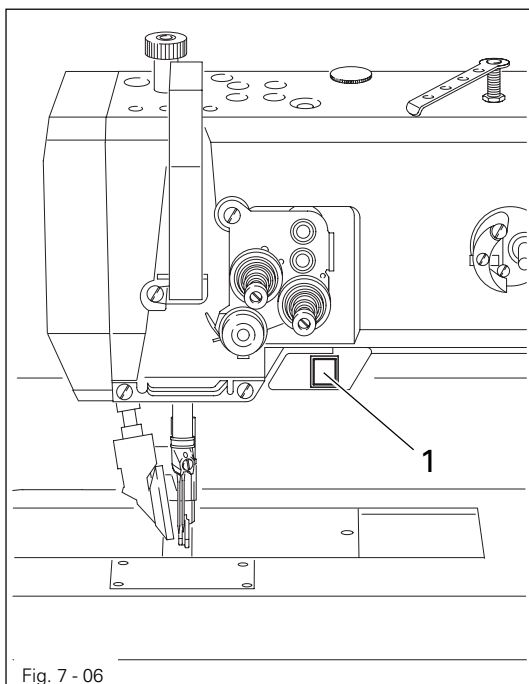

- If key 1 is pressed during sewing, the machine will switch to reverse sewing.

7.06 Lever for lifting the roller presser

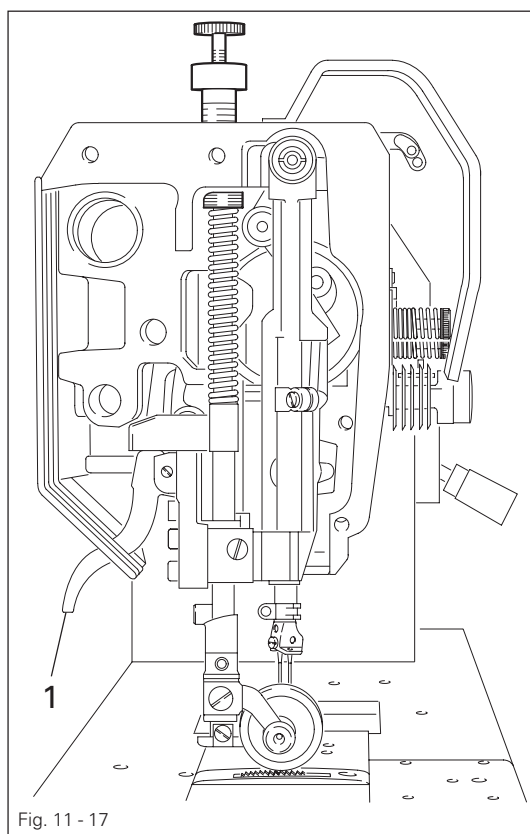

- The roller presser is lifted by raising lever 1.

## 7.07 Feed regulator/reverse sewing

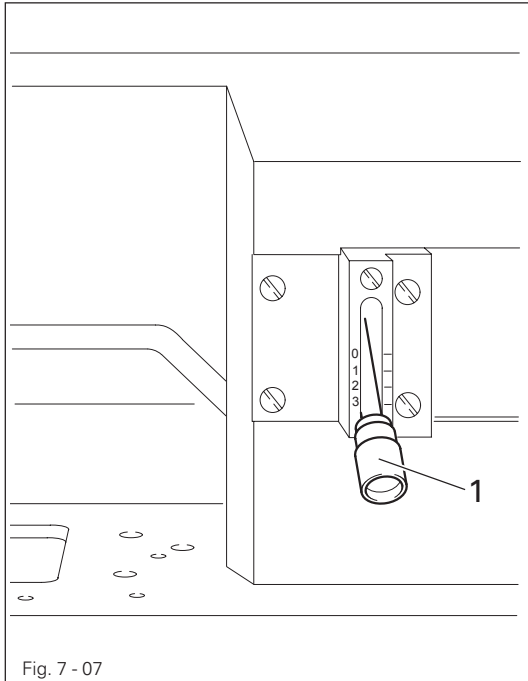

- The stitch length is adjusted by turning the knurled nut on lever 1.
- To reverse the sewing direction press lever 1 fully upwards.

## 7.08 Feed regulator (on machines with subclass -911/97)

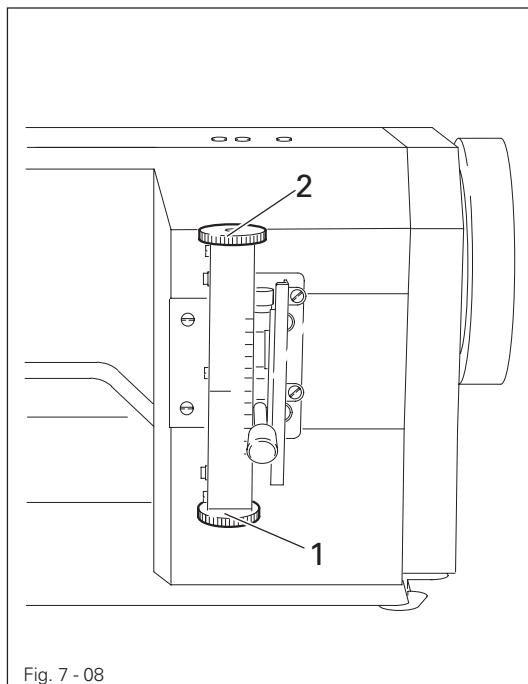

- Turn knurled screw 1 to adjust the stitch length for sewing forwards.
- Turn knurled screw 2 to adjust the stitch length for sewing backwards.



Reverse stitches can be set as long as required, independently of forward stitches.

**7.09**      **Control panel** (only on machines with attached motor)

The description can be found in the separate instruction manual for the control panel.

## 8 Installation and commissioning



The machine must only be mounted and commissioned by qualified personnel!  
All relevant safety regulations are to be observed!



If the machine is delivered without a table, it must be ensured that the frame and the table top which you intend to use can hold the weight of the machine and the motor. It must be ensured that the supporting structure is sufficiently sturdy, including during all sewing operations.

### 8.01 Installation

The site where the machine is installed must be provided with suitable connections for the electric current, see **Chapter 3 Specifications**

It must also be ensured that the standing surface of the machine site is firm and horizontal, and that sufficient lighting is provided.



The method of packaging used requires that the table top be lowered for transport. The following is a description of how to adjust the height of the table top.

#### 8.01.01 Adjusting the table-top height

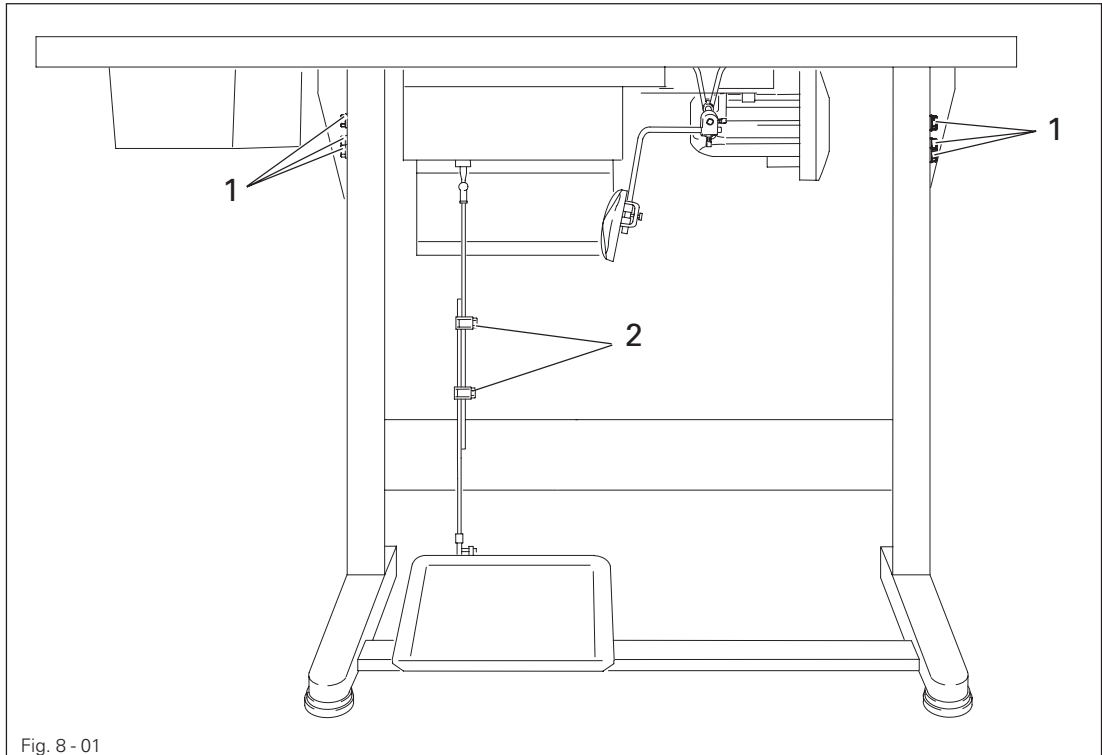

- Loosen screws **1** and **2** and set the desired table-top height
- Tighten screws **1** well.
- Adjust the position of the pedal so that you can operate it comfortably and tighten screw **2**.

## 8.01.02 Assembling the motor (only on machines with motor)

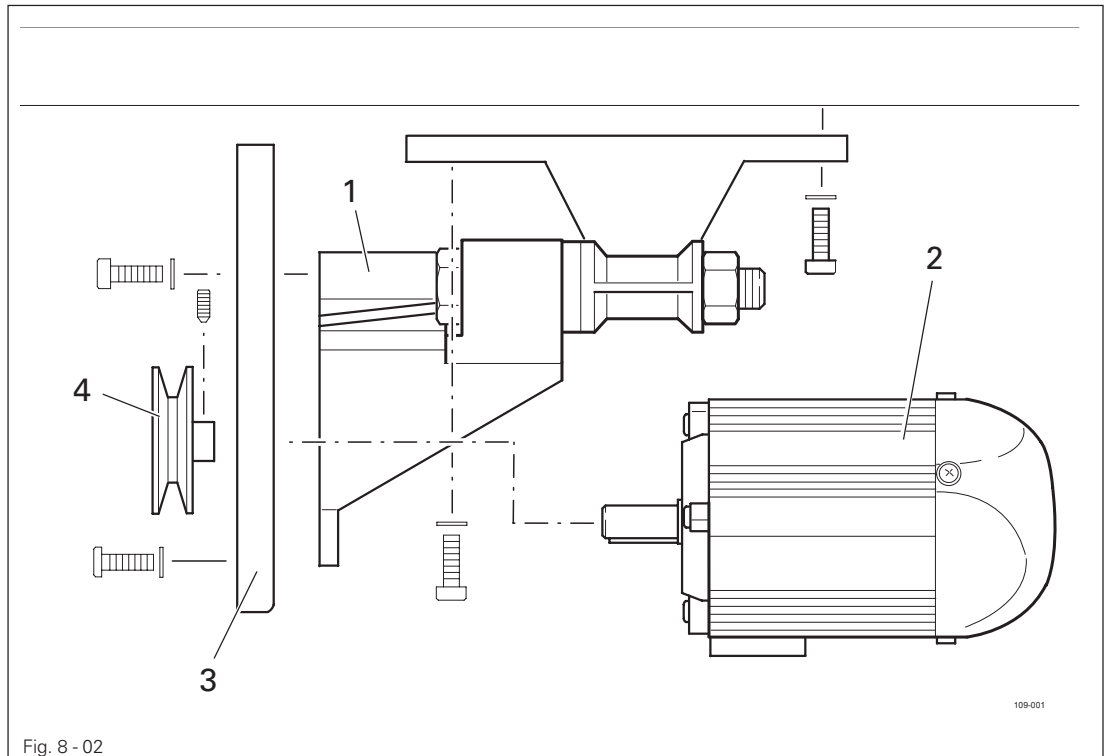

Fig. 8 - 02

- Assemble motor mounting 1, motor 2, belt guard support 3 and belt pulley 4 as shown in Fig. 8-02.

## 8.01.03 Tightening the V-belt

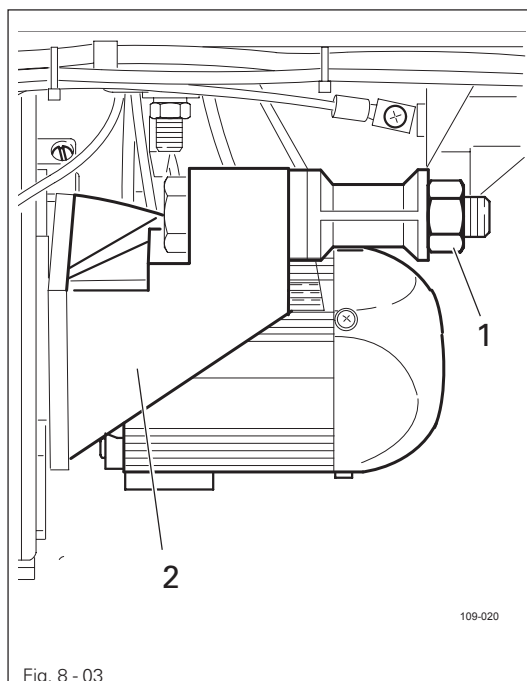
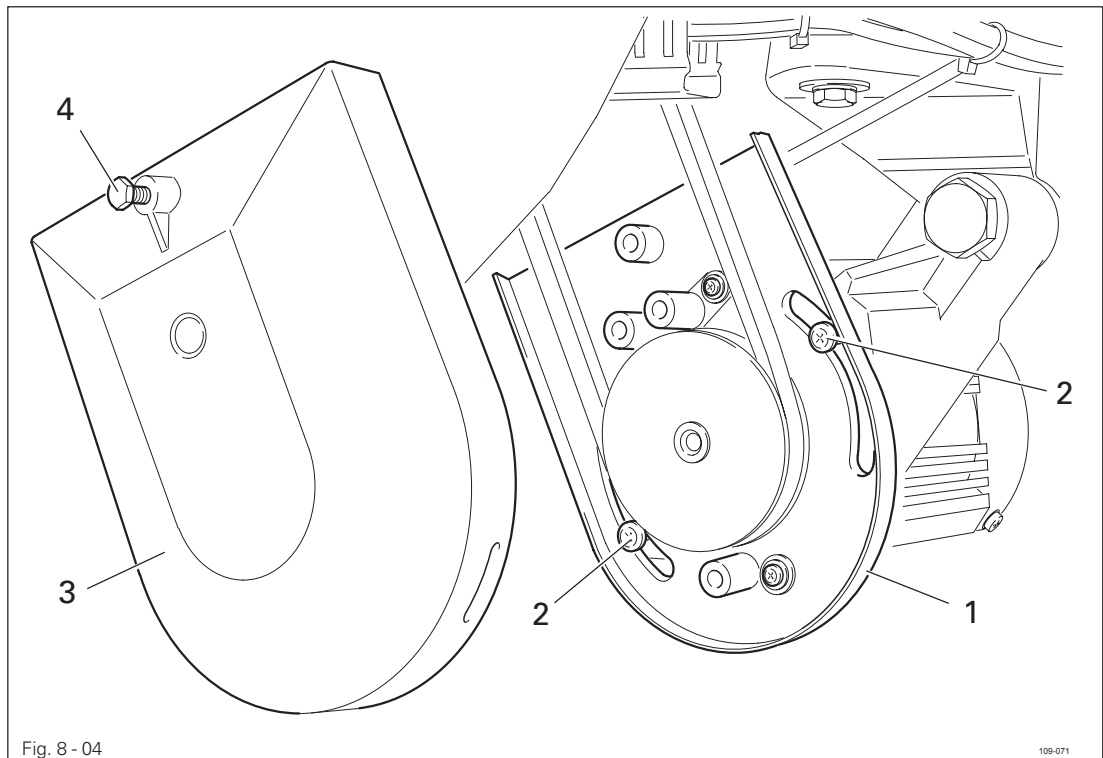

Fig. 8 - 03

- Fit the V-belt.
- Loosen nut 1 and tighten the V-belt by turning motor mounting 2.
- Tighten nut 1.

## Installation and commissioning

### 8.01.04 Mounting the bottom V-belt guard



- Loosen screws 2 and adjust belt guard support 1 so that the motor pulley and V-belt run freely.
- Tighten screws 2.
- Fasten belt guard 3 with screw 4.



Fig. 8-04 shows a motor. If a different motor is used, follow the instructions of the Motor Instruction Manual.

## 8.01.05 Mounting the upper V-belt guard

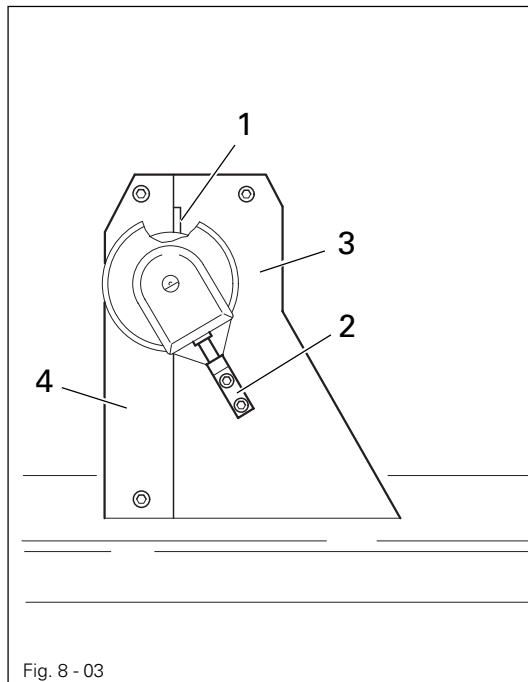

If a large balance wheel is used, the corner 1 of the belt guard 3 must be broken out.

- Screw position stop 2 to the belt guard section 3.
- Attach belt guard section 3.
- Attach belt guard section 4.

## 8.01.06 Fitting the synchronizer

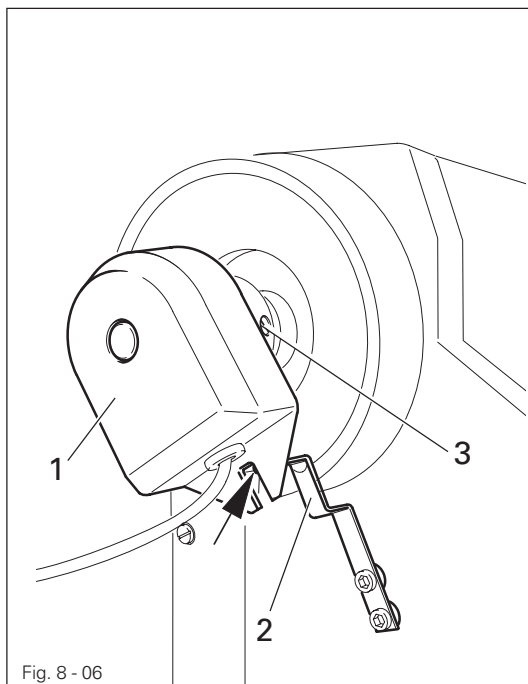

- Push synchronizer 1 onto the shaft so that stop 2 is standing in the slot on the synchronizer (see arrow)
- Tighten screws 3.
- Connect the synchronizer plug to the control box.
- Connect the synchronizer plug to the adapter (see Chapter 8.02 Connecting the plug connections and earth cables).
- Adjust the synchronizer 1, see Chapter 8.05 Basic position of the machine.

# Aufstellung und erste Inbetriebnahme

## 8.01.07 Fitting the tilt lock

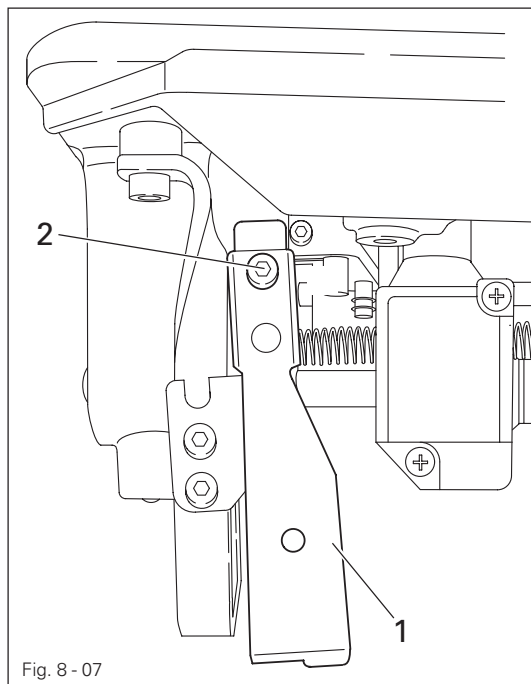

Switch off the machine!  
Danger of injury due to  
unintentional starting of the  
machine!

- Screw on tilt lock **1**, provided in the accessories, using screw **2**.



Do not operate the machine  
without tilt lock **1**!  
Danger of crushing between  
sewing head and table top!

## 8.01.08 Fitting the reel stand

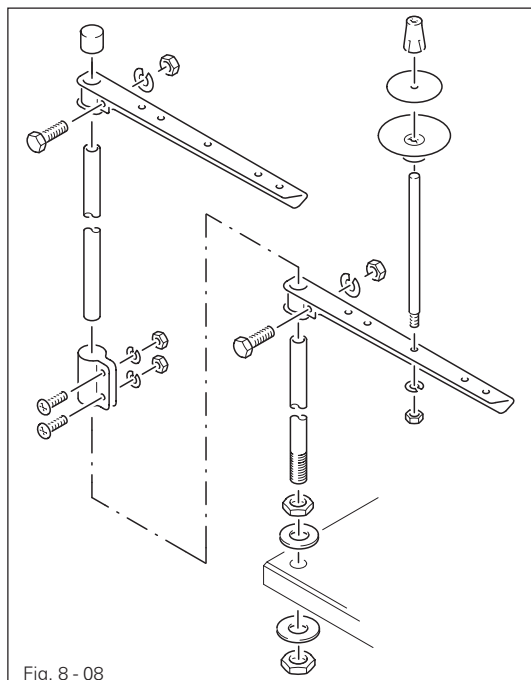

- Fit the reel stand as shown in **Fig. 8 - 08**.
- Afterwards insert the stand in the hole in the table top and secure it with nuts provided.



Table top mounting and circuit diagrams  
(see Chapter 11)



## 8.02

### Connecting the plug-in connections and earth cables

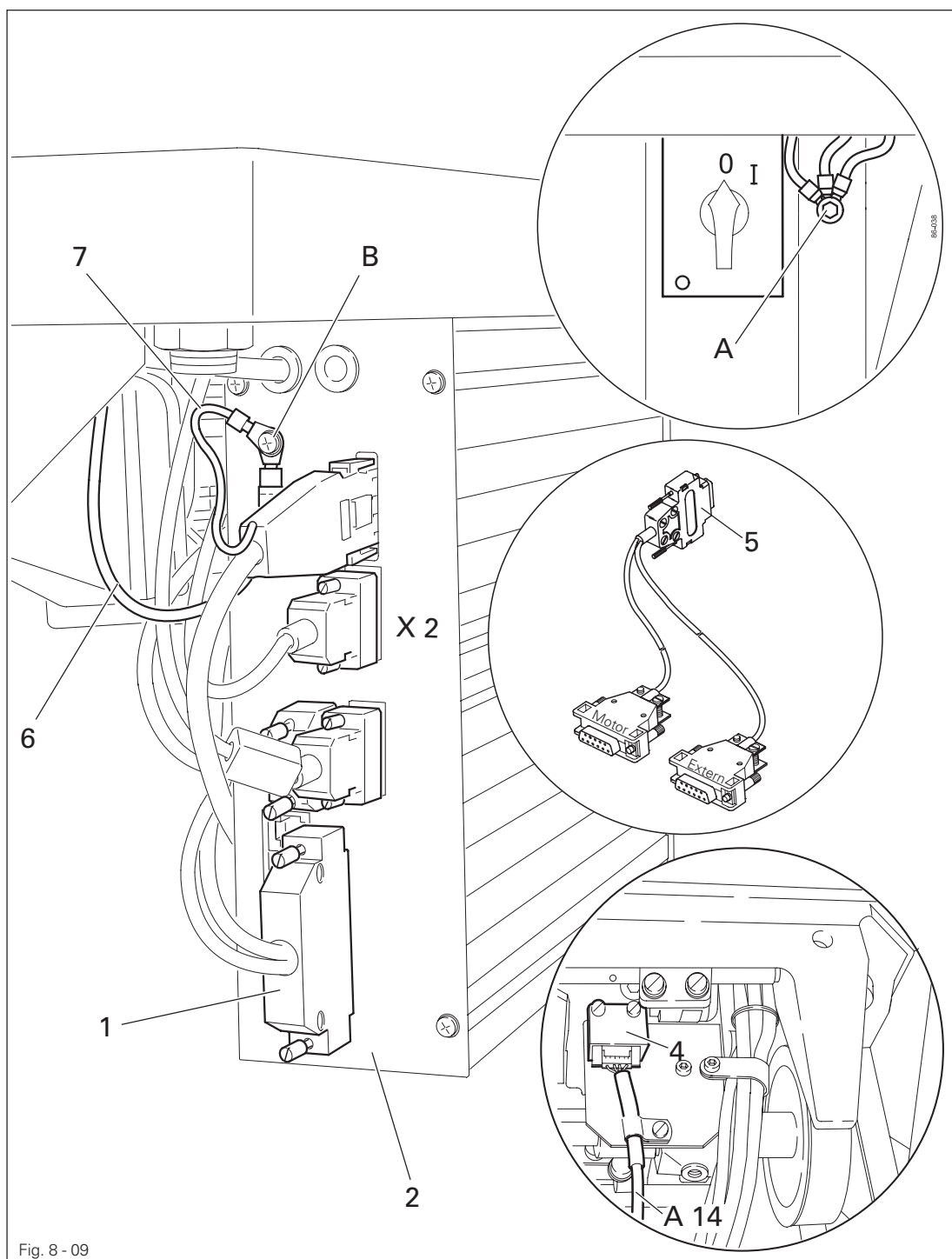
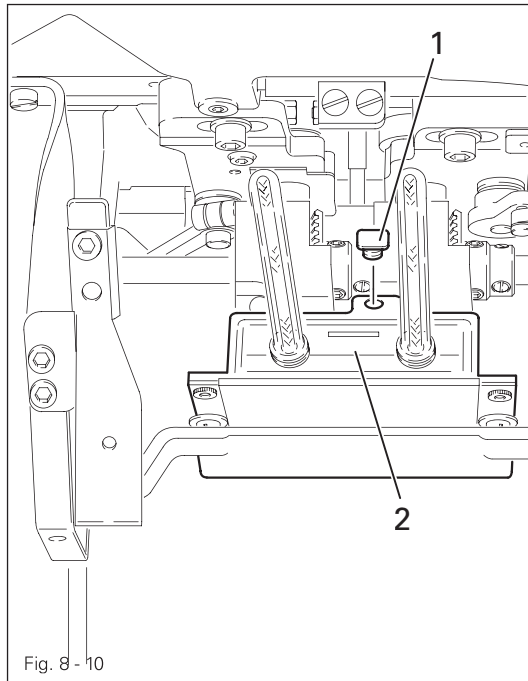

Fig. 8 - 09

- Plug adapter cable 1 into control box 2.
- Plug the cable coming from the machine to adapter cable 1 as marked.
- Plug the cable A14 coming from adapter 1 to the sewing head recognition unit 4.
- Insert plug 5 from the adapter cable to bush X 2.
- Connect the motor to the "motor" plug and the synchronizer to the "external" plug.
- Screw the earth cable from the sewing head and the main switch to earth point A.
- Connect earth point A to earth point B with earth cable 6.
- Screw the earth cable 7 from the motor to earth point B.

## 8.03 Commissioning

- Clean the machine thoroughly and oil it (see chapter 10 **Care and maintenance**).
- Check the machine, particularly its electrical wiring and pneumatic tube connections, for any damage.
- Have skilled personnel check if the machine can be operated with the available mains voltage.



- Remove pin 1 of the oil reservoir 2 (Fig. 8 - 10). The pin serves only to protect the machine from damage during transport and must not be used when sewing.



Do not operate the machine if there is any discrepancy.



Before commissioning the machine, have specialized personnel check whether the parameter 799 (machine class) is set at "2" and the parameter 800 (sewing direction) is set at "1". If necessary, have the adjustment carried out (see Chapter 8.05 **Basic position of the machine drive unit**).



The machine may only be connected to an earthed socket!

- Connect the machine to the compressed air supply. When it is connected, the gauge should show a pressure of approx. 6 bar. If necessary, have this reading correctly set (see Chapter 10.06, **Checking/adjusting the air pressure**).

## 8.04 Switching the machine on/off

- Switch the machine on (see Chapter 7.01, **On/off switch**).

### 8.05 Basic position of the machine drive unit

(only on machines with EcoDrive and control unit P40ED)

- Switch on the machine.
- Press the **TE/speed key** twice to select the input mode.
- Select parameter "**798**" by pressing the corresponding +/- key, and select service level C, see Chapter **Selecting the user level** in the instruction manual for the control panel.
- By pressing the corresponding +/- key select the parameter "**799**" (Selecting the machine class).
- Check whether value "**2**" is set, and correct it if necessary.



If the parameter has to be altered, operate the off the machine and switch it on again. Then select service level C again as described above.

- - By pressing the corresponding +/- key, select parameter "**800**" (selecting the sewing direction).
  - By pressing the corresponding +/- key, select the value for the parameter at "**1**".
  - By pressing the corresponding +/- key, select parameter "**700**".
  - Sew a stitch by operating the pedal.
  - Turn the balance wheel in the sewing direction until the descending needle is level with the top edge of the needle plate.
  - Then check the parameter values listed in the parameter list (see Chapter **10.08 Parameter Settings**) and adjust them if necessary.
  - Conclude the adjustment of the sewing motor by pressing the **TE/Speed key**.

9

## Rüsten



Alle Vorschriften und Hinweise dieser Betriebsanleitung sind zu beachten. Die besondere Aufmerksamkeit gilt allen Sicherheitsvorschriften!



Alle Rüstarbeiten dürfen nur durch entsprechend unterwiesenes Personal durchgeführt werden. Bei allen Rüstarbeiten sind die Maschinen durch Betätigen des Hauptschalters oder durch Herausziehen des Netzsteckers vom elektrischen Netz zu trennen!

9.01

### Nadel einsetzen bei der PFAFF 1243

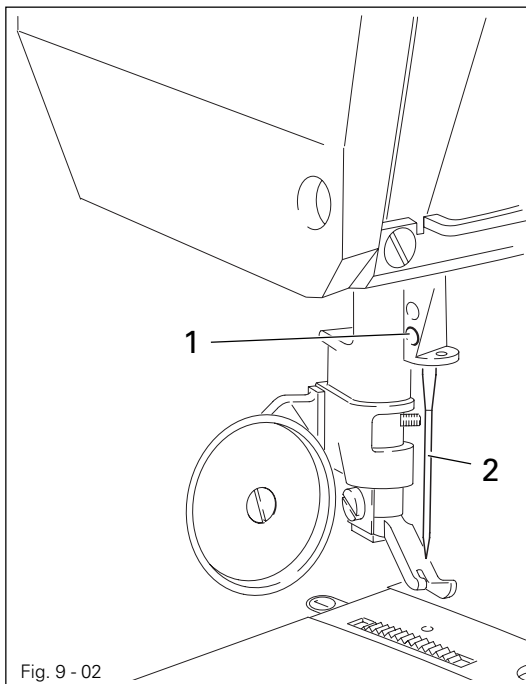

Maschine ausschalten!  
Verletzungsgefahr durch unbeabsichtigtes Anlaufen der Maschine!



Nur Nadeln des für die Maschine vorgesehenen Systems verwenden, siehe **Kapitel 3 Technische Daten**.

- Rollfuß anheben und ausklappen.
- Nadelstange in Hochstellung bringen und Schraube 1 lösen.
- Nadel 2 bis zum Anschlag einsetzen ( die lange Nadelrille muß dabei nach links zeigen ).
- Schraube 1 festdrehen.



Die Nadelauswahl ist abhängig von der Ausführungsart der Maschine und dem zu verarbeitendem Faden und Material ( siehe **Kapitel 3 Technische Daten** ).

9.02

Inserting the needles on the PFAFF 1244

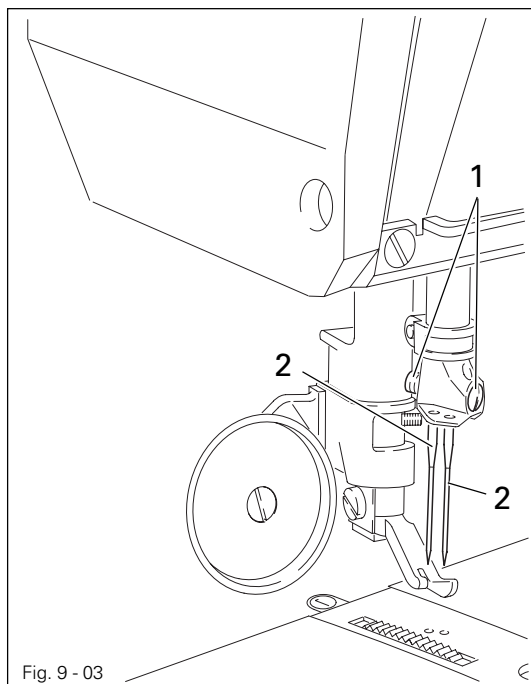

Switch the machine off!  
Danger due to unintentional starting of the machine!



Only use needles from the system intended for the machine, see Chapter 3 Specifications.

- Raise the roller presser and swing it out.
- Set needle bar at top position and loosen screws 1.
- Push needles 2 fully in (the long groove of the left needle must face to the right and that of the right needle to the left).
- Tighten screws 1 again.



The choice of needle depends on the version of the machine and the sewing thread and material in use (see Chapter 3, Specifications).

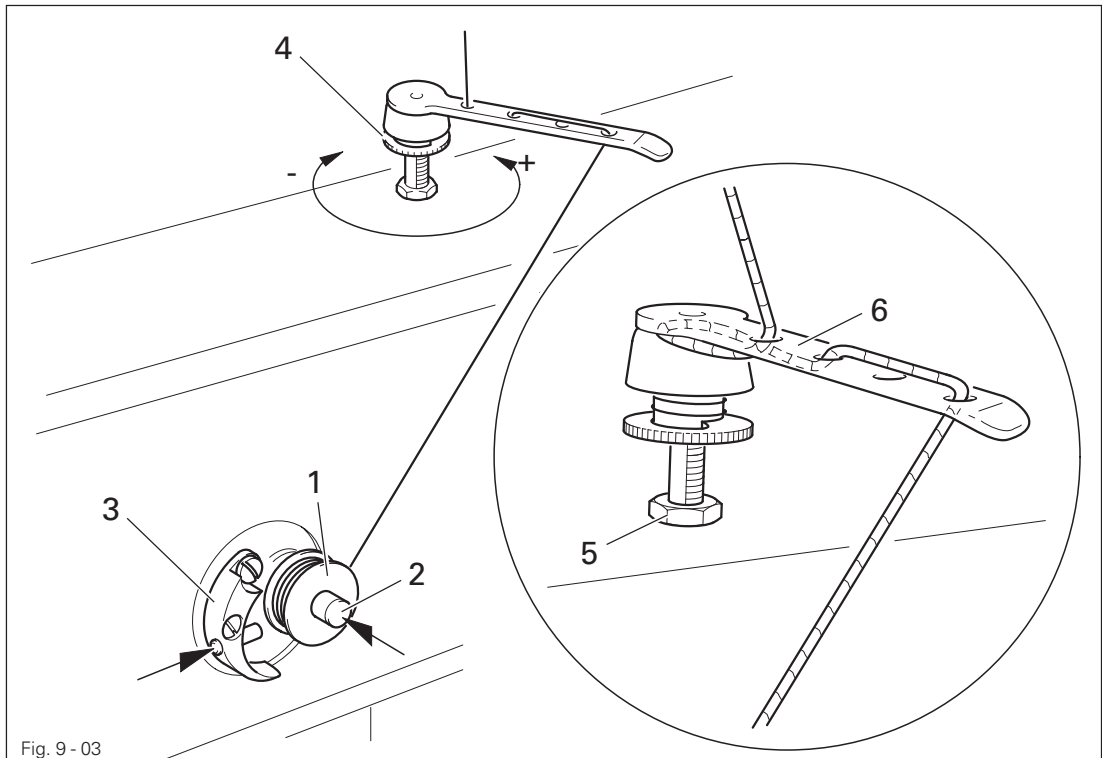

Fig. 9-03

- Place an empty bobbin 1 on winder spindle 1.
- Thread up as shown in Fig. 9-03 and wind the thread a few times clockwise around bobbin 1.
- Engage the bobbin winder by pressing spindle 2 and lever 3 simultaneously



The bobbin is wound during sewing.

- The tension of the thread wound onto bobbin 1 is set on knurled screw 4.
- The bobbin winder will stop when sufficient thread is wound onto bobbin 1.

If the thread is wound on unevenly:

- Loosen nut 5.
- Turn thread guide 6 as required.
- Tighten nut 5 again.

9.04 Removing /inserting the bobbin case

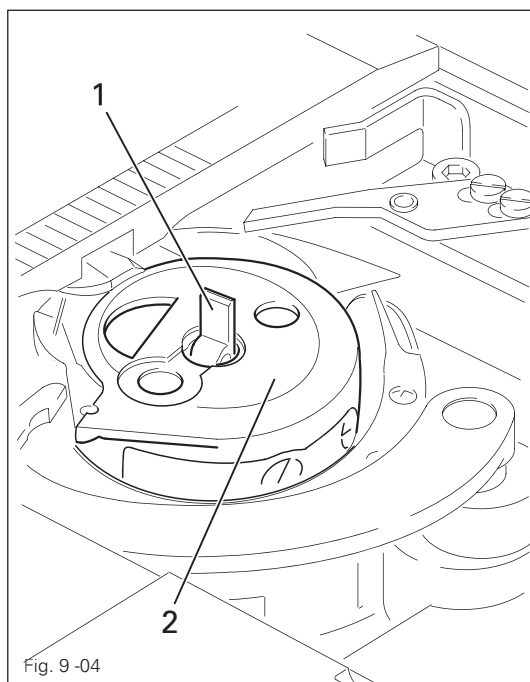

Switch the machine off!  
 Danger of injury if the machine is started accidentally!

Removing the bobbin case:

- Insert bobbin case 2 so that it clicks into place.
- Close the latch 1 and close the cover of the hook compartment.

Inserting the bobbin case:

- Insert bobbin case 2 so that it clicks into place.
- Close the latch 1 and close the cover of the hook compartment.



Do not operate the machine when the cover of the hook compartment is open!  
 Danger of injury by moving parts!

9.05 Threading the bobbin case / adjusting the thread tension

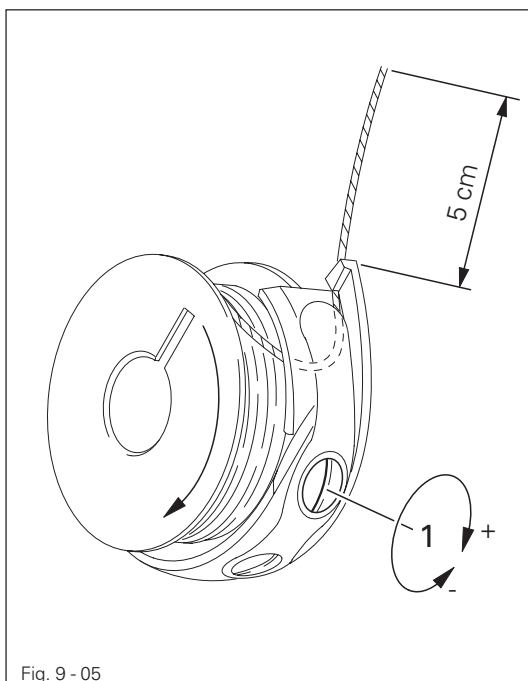

Turn the machine off!  
 Danger of injury if the machine is started accidentally!

- Thread the bobbin as shown in Fig. 9-05.
- When the thread is pulled, the bobbin must rotate in the direction of the arrow.
- Adjust the bobbin thread tension with screw 1.

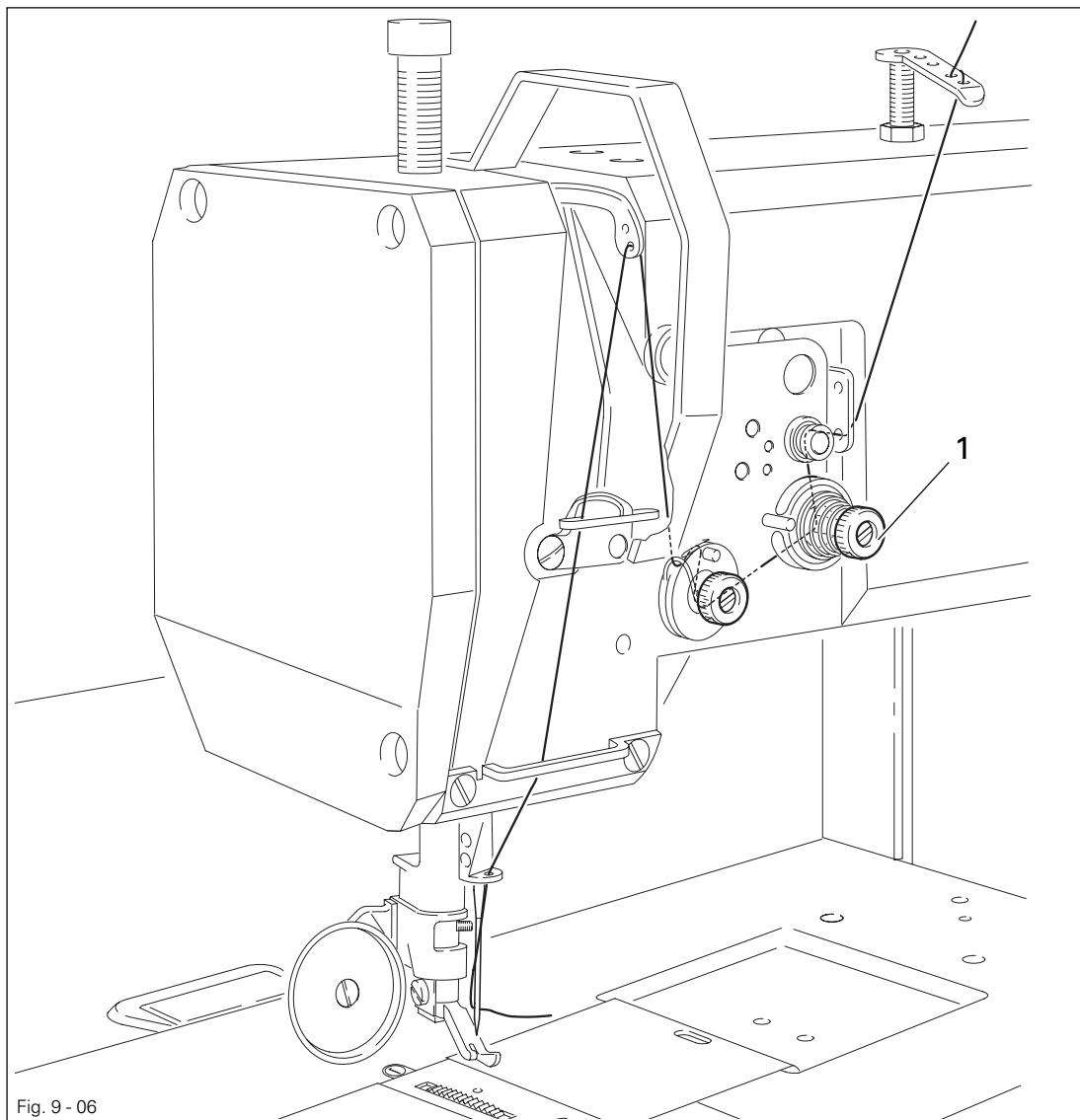

Turn the machine off!

Danger of injury if the machine is started accidentally!

- Thread the needle thread as shown in **Fig. 9-06**. Take care that the needle is threaded from the left.
- Adjust the needle thread tension by turning the knurled screw **1**.



9.07

Threading the needle thread / adjusting the needle thread tension PFAFF 1244

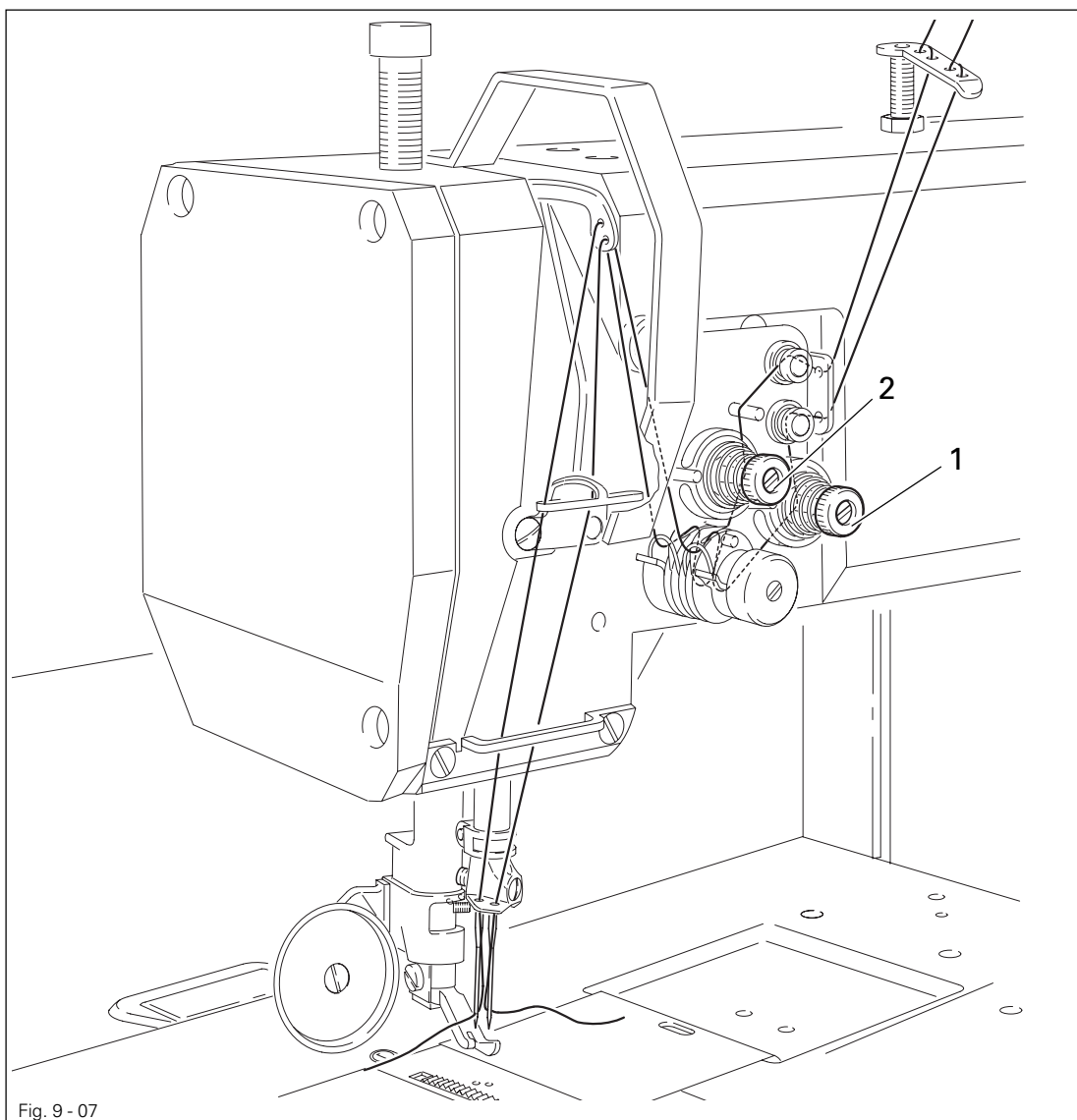

Fig. 9 - 07



Turn the machine off!  
 Danger of injury if the machine is started accidentally!

- Thread the needle thread as shown in Fig. 9-07. Take care that the right needle is threaded from the left and the left needle from the right.
- Adjust the needle thread tension by turning the knurled screw **1** (right needle) or **2** (left needle).

9.08      **Adjusting the stitch counter for the bobbin thread control**  
(only on machines with Motor and P40 (ED) control unit)

Please see the description in the separate control panel instruction manual.

10 Car and maintenance

10.01 Servicing and maintenance intervals

Check the air pressure .....	daily, before use
Clean the hook compartment .....	daily, several times if in continuous operation
Clean the water container of the air filter/regulator .....	daily, before use
Oil hook .....	daily
General oiling .....	twice a week
Lubricate the needle-head parts .....	twice a week
Clean the hook .....	once a week



These maintenance intervals are calculated for the average running time of a single shift operation. If the machine is operated for a longer period, shorter intervals are recommended.

10.02 Cleaning the hook compartment and the hook

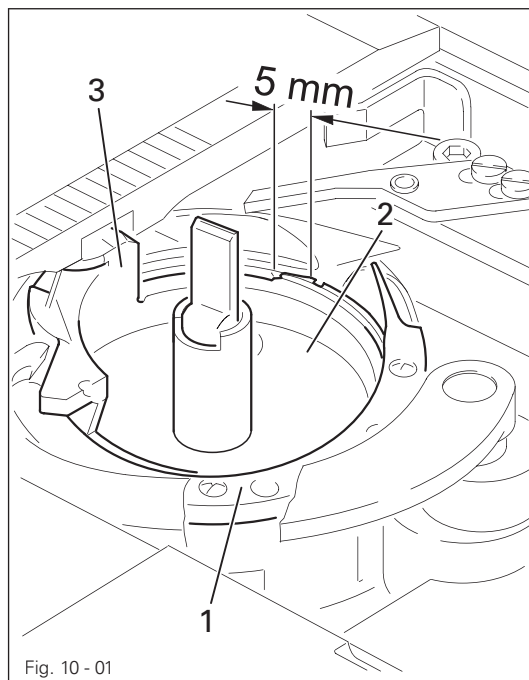

Turn the machine off!  
Danger of injury if the machine is started accidentally!

- Clean the hook compartment daily with a brush, several times if in continuous operation.
- Clean the hook thoroughly once a week.
- Open the hook compartment cover.
- Raise the needle bar as far as possible.
- Remove the bobbin case cap and the bobbin.
- Unscrew hook jib 1.
- Turn the balance wheel, until the tip of the bobbin case 2 penetrates approx. **5 mm** into the groove of the hook race.
- In this position remove the bobbin case 2.
- Clean the hook race with paraffin.
- When inserting the bobbin case, ensure that horn 3 fits into the groove of the needle plate.
- Screw hook jib 1 back on.
- Insert the bobbin case and close the cover of the hook compartment.

## 10.03 General lubrication

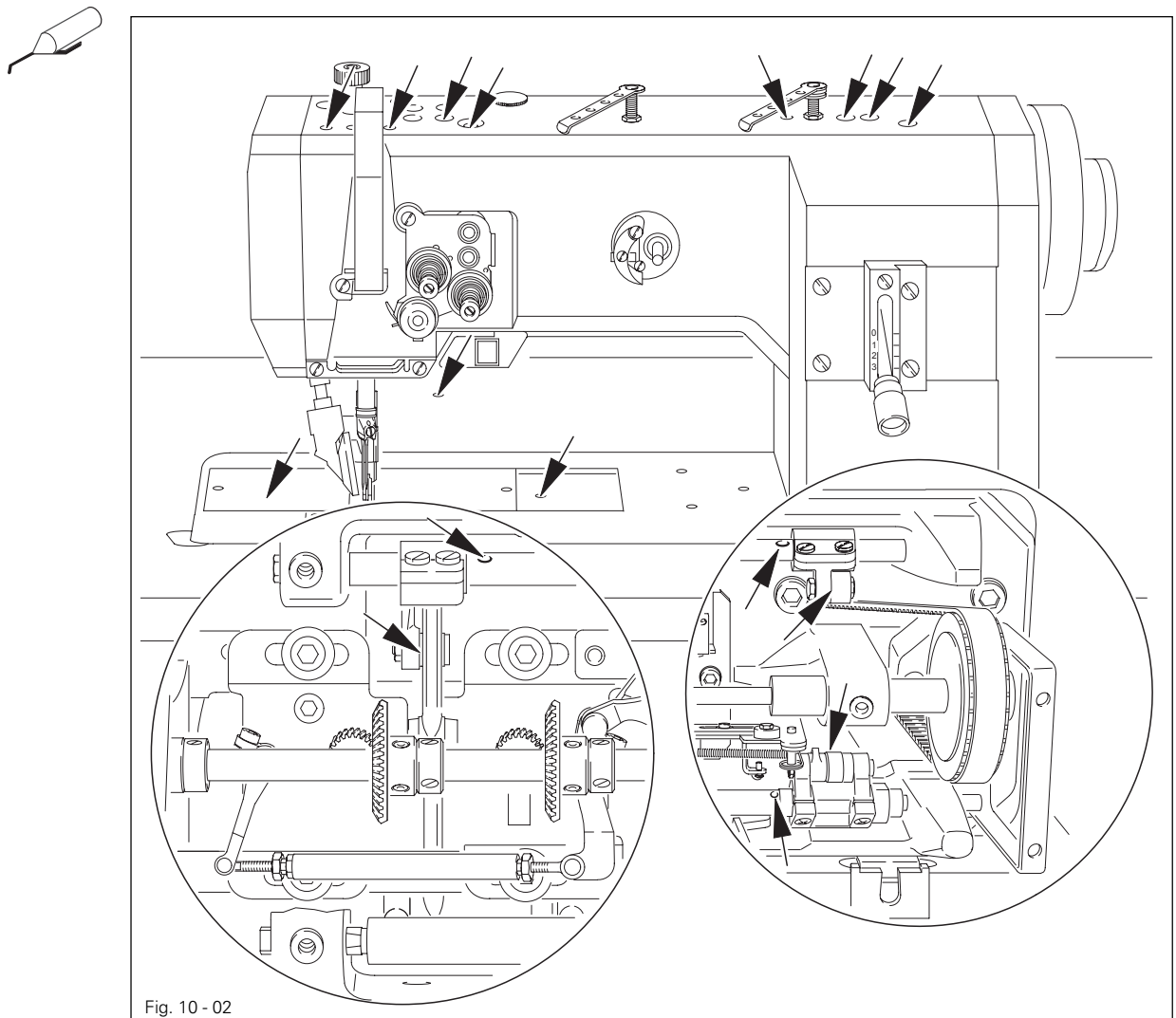

- Lubricate all bearings above the table top (see arrows) twice a week.



Switch off the machine!

Danger of injury due to unintentional starting of the machine!

- Pull the knee lever out to the front and tilt the machine backwards.
- Lubricate all bearings below the table top (see arrows) twice a week.



Only use oil with a mean viscosity of 22.0 mm<sup>2</sup>/s at 40° C and a density of 0.865 g/cm<sup>3</sup> at 15° C!

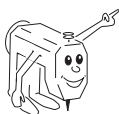

We recommend PFAFF sewing machine oil, Order-No. 280-1-120 144.



Using both hands, set the machine into an upright position!  
Danger of crushing between the machine and table top!

### 10.04 Lubricating the hook

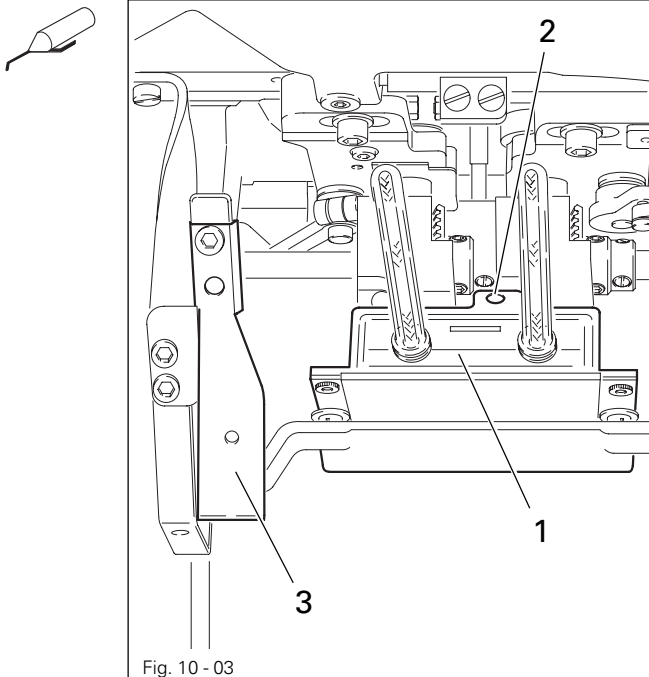

Turn the machine off!  
Danger of injury if the machine is started accidentally!

- Pull the knee lever out to the front and tilt the machine backwards.
- Fill oil reservoir 1 through hole 2 up to the top marking.



Only use oil with a mean viscosity of 22.0 mm<sup>2</sup>/s at 40° C and a density of 0.865 g/cm<sup>3</sup> at 15° C!

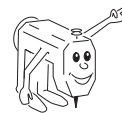

We recommend PFAFF sewing machine oil. Order-No. 280-1-120 144.

#### Setting the machine upright

- Hold the machine firmly, press tilt safety device 3 and, using both hands, set the machine into an upright position.



Danger of crushing between the machine and table top!

### 10.05 Lubricating the needle head parts

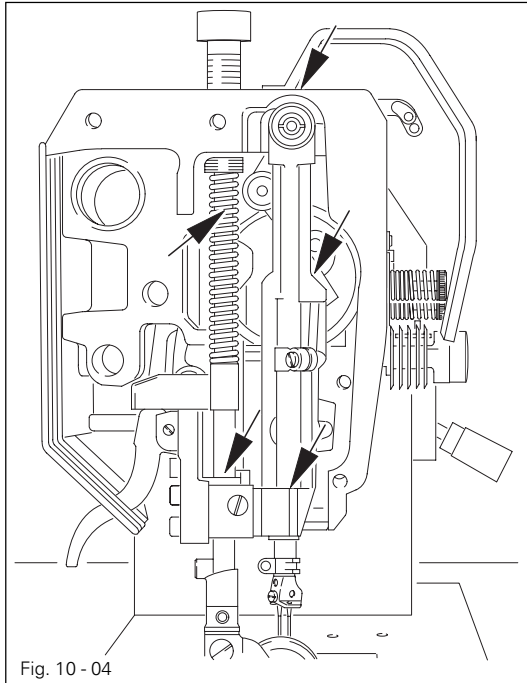

Fig. 10 - 04



Turn the machine off!  
Danger of injury if the machine is started accidentally!

- Unscrew the face plate.
- Lubricate all bearings and moving parts (see arrows) twice a week.
- Re-fit the face plate.



Only use oil with a mean viscosity of  $22.0 \text{ mm}^2/\text{s}$  at  $40^\circ \text{C}$  and a density of  $0.865 \text{ g/cm}^3$  at  $15^\circ \text{C}$ !



We recommend PFAFF sewing machine oil. Order-No. 280-1-120 144.

### 10.06 Checking and adjusting the air pressure

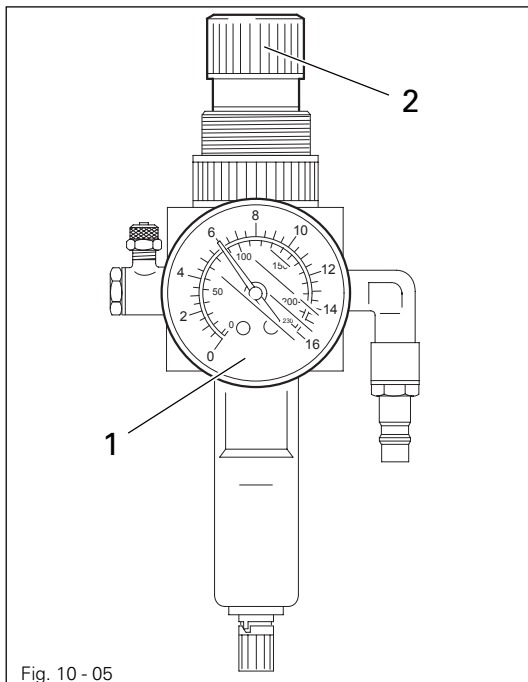

Fig. 10 - 05

- Before each use of the machine, check the air pressure on gauge 1.
- The gauge 1 must display a pressure of 6 bar.
- If necessary, alter the pressure to this level. To do so, lift knob 2 and turn it until the required pressure is reached.

10.07 Emptying/cleaning the water container of the air filter/regulator

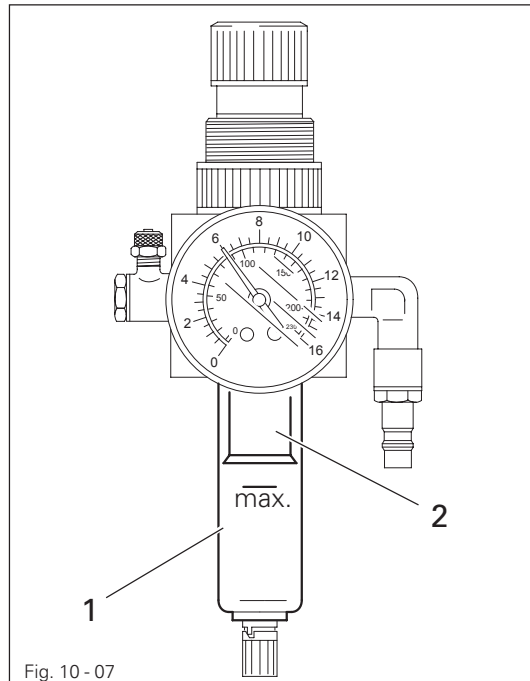

Fig. 10 - 07



Turn the machine off.  
Remove the compressed air  
hose from the air filter

**Emptying the water container**

- The water container 1 empties itself automatically when the compressed-air hose is removed from the air filter/regulator.

**Cleaning the filter**

- Unscrew water container 1 and remove filter 2.
- Clean the filter with compressed air or with isopropyl alcohol, order number 95-665 735-91.
- Screw filter 2 back into place and screw water container 1 back on.

# Care and maintenance

## 10.08 Parameter settings

(only on machines with EcoDrive and control unit P40ED)

- The selection of the user level and the alteration of parameters is described in the separate instruction manual for the drive unit.

### 10.08.01 Parameter list

Group	Parameter	Description	User level	Setting range	Set value
1	105	Speed for start backtack	B, C	100 - 2000	700
	110	Speed for end backtack	B, C	100 - 2000	700
6	607	Speed max.	B, C	300 - 3200	▲
	609	Cutting speed 1	B, C	60 - 300	180
7	700	Needle position 0 (needle reference position)	B, C	0 - 255	*
	702	Needle position 1 (needle lowered)	B, C	0 - 255	15
	703	Needle position 2 (take-up lever raised)	B, C	0 - 255	230
	705	Needle position 5 (end cutting signal 1)	B, C	0 - 255	200
	706	Needle position 6 (start cutting signal 2)	B, C	0 - 255	15
	707	Needle position 9 (start thread tension release/start thread catcher)	B, C	0 - 255	195
	722	Acceleration ramp	B,C	1 - 60	50
	723	Brake ramp	B,C	1 - 60	40
	734	Tact output A2 (thread trimming)	B,C	0 - 90	40
	760	Multiplier for the fixed value (200) for stitch count	A, B, C	0 - 250	5
799	Selected machine class	C	1 - 8	2	

▲ See Chapter 3 Specifications

\* Adjustment see Chapter 8.05 Basic position of the machine drive unit .



Group	Parameter	Description	User lever	Setting range	Set value
8	800	Rotating direction of the motor	C	0 - 1	1
	884	Proportional sensitivity of the speed control unit	B,C	3 - 30	16
	897	Variant mini-motor, 1 = long, 2 = short	C	0 - 1	1
9	900	Additional P- sensitivity of the speed control unit	B,C	1 - 30	16



Further parameters and the description for an internet update of the machine software and reset /cold start of the machine can be found in the instruction manual for the control panel.





## 11.03 Circuit diagrams

### Reference list for the Circuit diagrams

A1	Control unit P40 ED
A2	Control panel BDF S2
A14	Sewing head recognition system (OTE)
H1	Sewing lamp (optional)
H10	LED stitch counter
M1	Sewing motor
Q1	Main switch
S1	Manual backtacking key
S1.1	Pedal speed control unit
S2	Needle position change key
S3	Single stitch key
S6	Start inhibitor (E6 stop)
X0	PC-interface (RS 232)
X1	Motor
X2	Incremental transducer
X2.1	Incremental transmitter adapter
X2.2	Synchronizer adapter
X2.3	Y5-911/.. backtacking device
X3	Speed control unit
X3.1	Y2 -900/.. thread trimmer (FS )
X4	A2 control panel plug BDF S2
X4.1	Y4 -910/.. automatic foot lift
X5	Out-/input
X6	Bobbin thread monitor (optional)
X6.1	Y8 Thread tension release
X7	Photoelectric barrier (optional)
X24	Y4 -910/.. automatic foot lift
X25	Y5 -911/.. backtacking device
X28	Y8 Thread tension release
X40	S1-3 Control panel
X50	A14 Sewing head recognition system (OTE)
Y2	-900/.. thread trimmer
Y4	-910/.. automatic foot lift
Y5	-911/.. backtacking device
Y8	Thread tension release

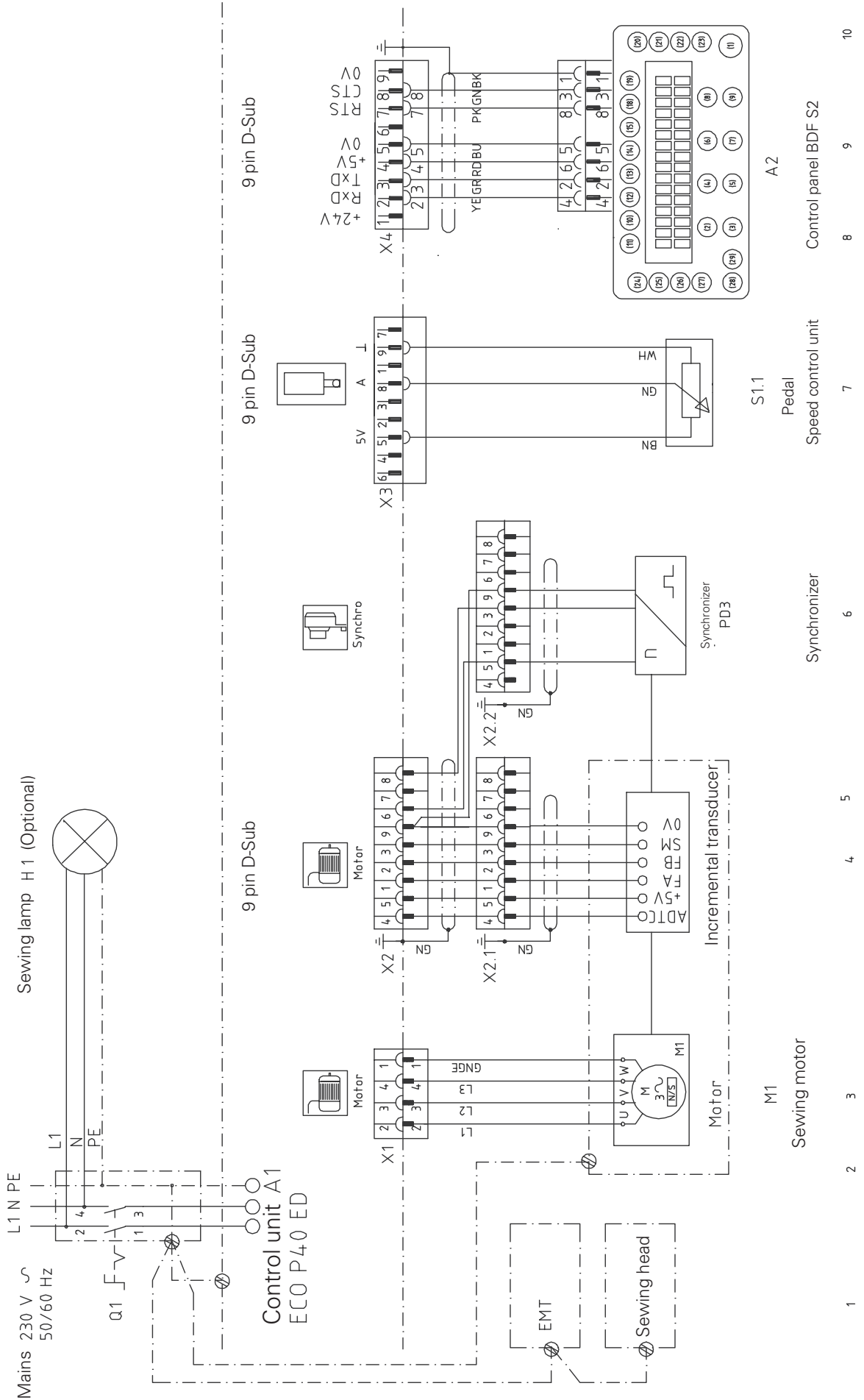

Control unit A1  
ECO P40 ED

Outputs and inputs  
37 pin D-Sub

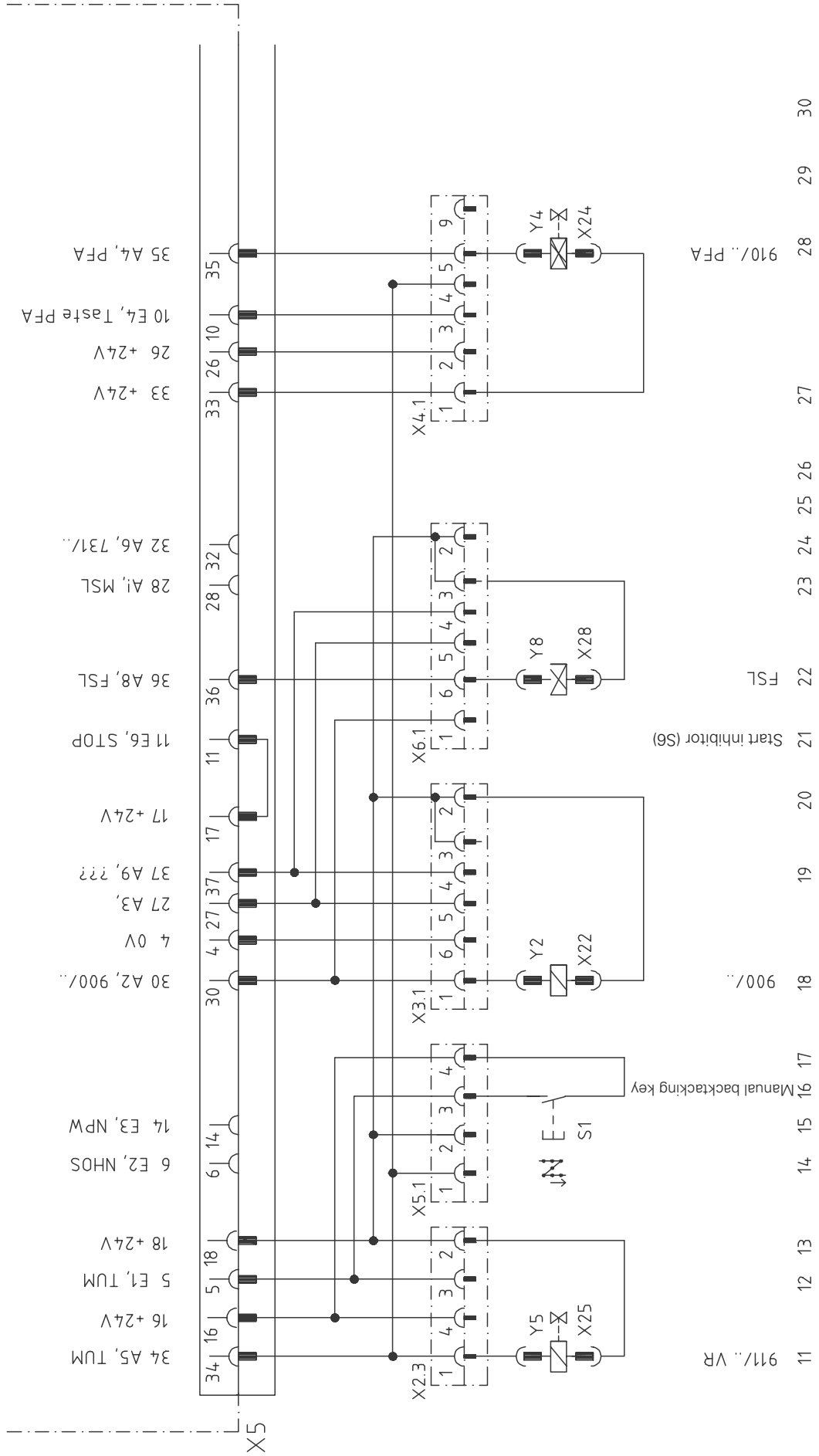

Steuergerät A1 P40 ED

Sonderfunktionen

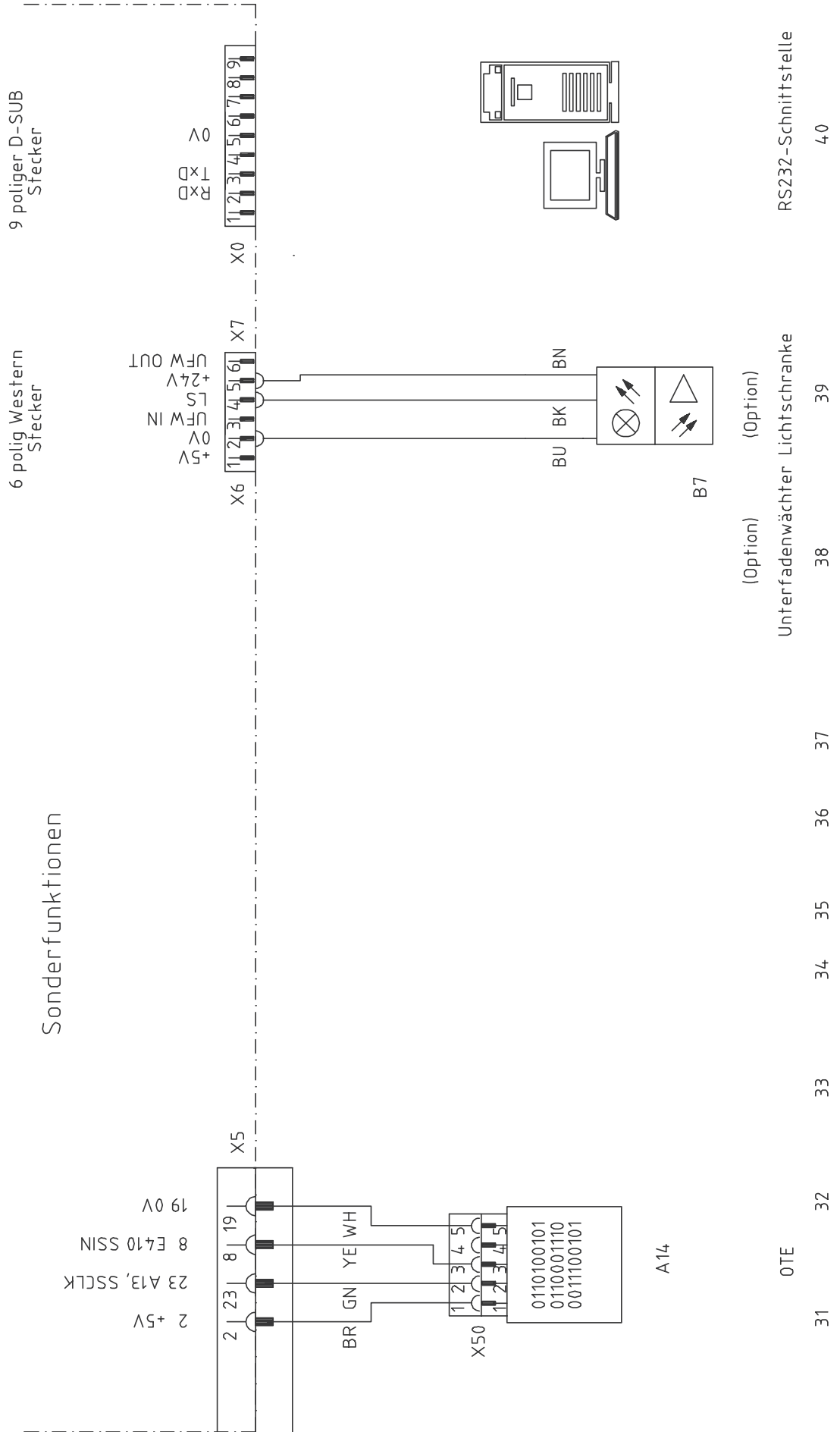



This is a list of the most important wearing parts.

A detailed parts list for the complete machine is included with the accessories.

In case of loss, the parts list can be downloaded from the internet address

[www.pfaff-industrial.com/pfaff/de/service/downloads](http://www.pfaff-industrial.com/pfaff/de/service/downloads)

the internet download the parts lists can also be ordered in book form under part no. 296-12-19 243.

PFAFF 1243

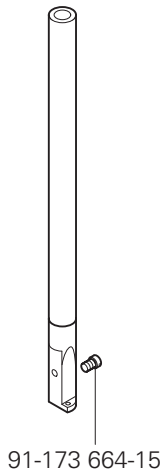

PFAFF 1244

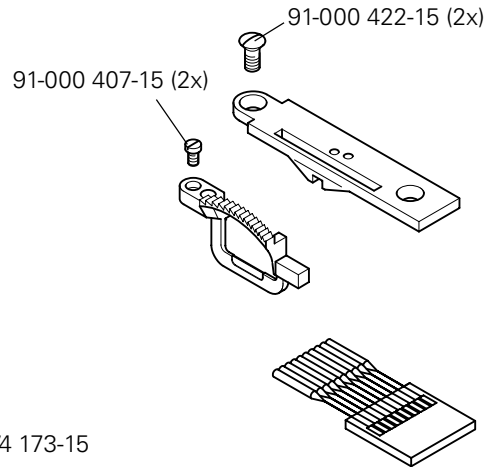
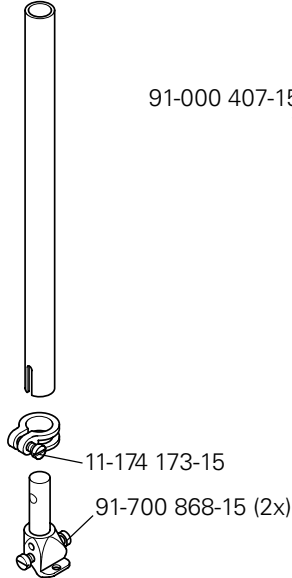

System 134

91-140 539-91  
91-140 451-91 (-900/56)

91-018 348-91  
91-140 287-91 (-900/56)

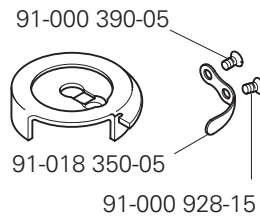

91-141 953-91  
91-141 958-91 (-900/56)

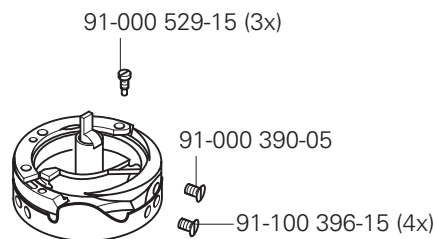

91-018 339-05  
91-018 480-05  
(-900/56)





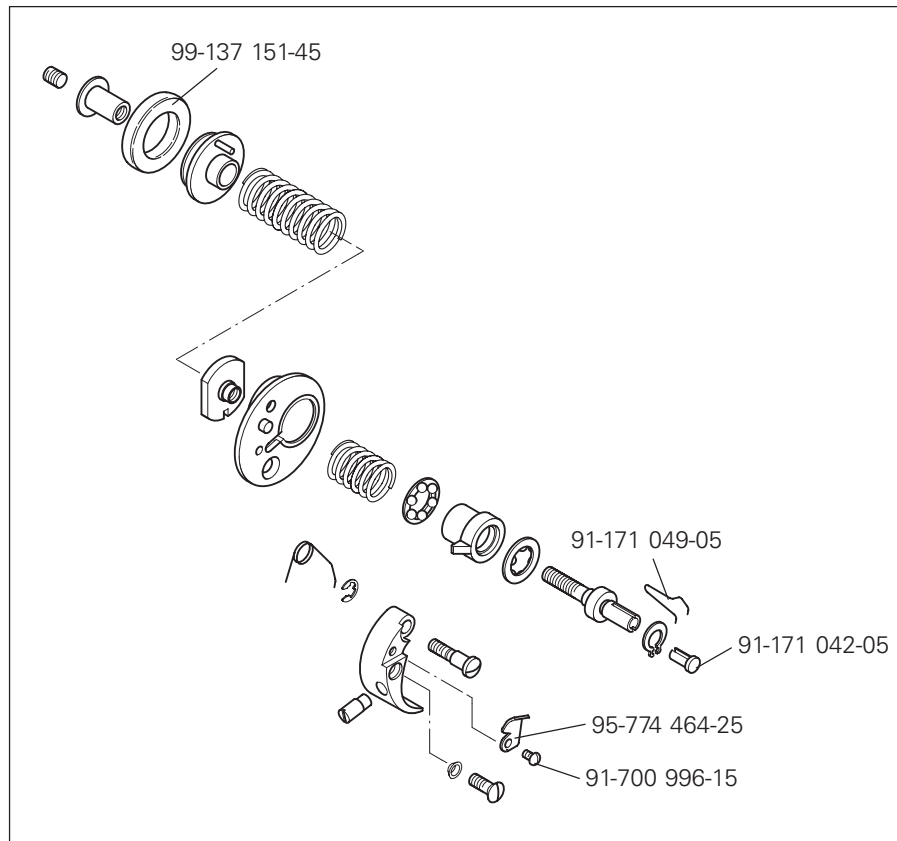

Subclass -900/56

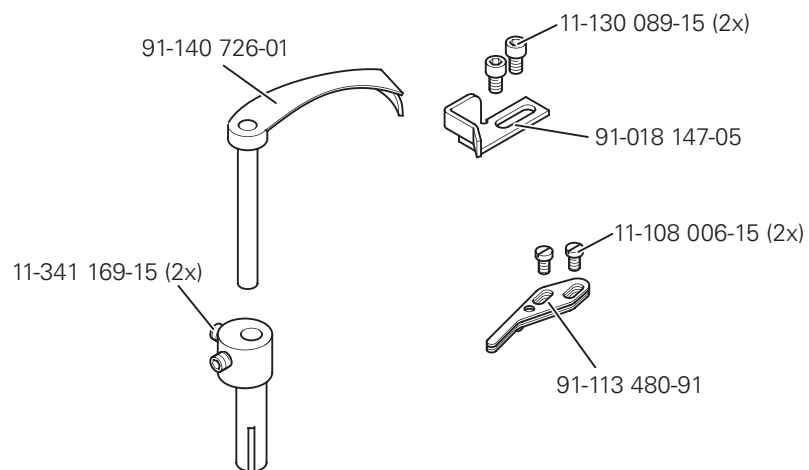

**PFAFF 1243; 1243-900/56; 1244**

91-010 937-05 (PFAFF 1243; 1243-900/56)  
 91-015 519-05 (PFAFF 1244)



**PFAFF 1244-900/56**





**Europäische Union**  
Wachstum durch Innovation – EFRE



## PFAFF Industriesysteme und Maschinen AG

Hans-Geiger-Str. 12 - IG Nord  
D-67661 Kaiserslautern

Telefon: +49-6301 3205 - 0  
Telefax: +49-6301 3205 - 1386  
E-mail: [info@pfaff-industrial.com](mailto:info@pfaff-industrial.com)